

The 1006 Series is also available in a **Complete One Box Solution**

HES® 1006 Electric Strike

Works with all cylindrical and mortise locksets with or without a deadbolt



The strongest, most versatile electric strike available.

The 1006 series is the strongest and most versatile electric strike available. The dual interlocking plunger design and heavy duty stainless steel construction, enables it to exceed every standard developed for electric strikes. With multiple faceplate options, the 1006 will fully accommodate every lock designed to work within an ANSI 4-7/8" strike plate. Tested to exceed 3,000 lbs of static strength, 350 ft-lbs of dynamic strength and factory tested to exceed 1 million cycles of operation, the 1006 is in a class of its own.

Features

Standard Features

- Stainless steel construction
- Tamper-resistant
- Static strength 2,500 lbs
- Dynamic strength 350 ft-lbs (fail secure)
- Endurance 1 million cycles
- Fail secure (Standard)
- Non-handed
- Accommodates up to 1" deadbolt
- Plug-in connector
- Full keeper shims for horizontal adjustment
- Trim enhancer
- Strike body depth 11/16"
- SecuriCare five-year, no fault, no questions asked warranty

Optional Features

- **LBM** Latchbolt monitor
- **LBSM** Latchbolt strike monitor
- Fail safe
- Interchangeable faceplates
- Monitor switches may not work with all faceplate options

Accessories

- **1000-102** Rain guard
- **1006-103** Full keeper shims
- **1000-104** Lip extension trim adapter
- **1006-105** Trim enhancer BLK (goof plate)
- **1006-109** Trim adapter
- **1000-110** Replacement strike plate
- **1000-130** KD filler plate
- **150** Strike latch guard
- **HES-CUT-MTK** Metal template kit
- **2005M3** SMART Pac® III



Grade 1



SecuriCare
Warranty



Mortise Locks
with Deadbolt



Mortise Locks
without
Deadbolt



Cylindrical
Locksets



Rim Exit
Devices



Specialty
Locksets



Dual Voltage
12/24



Fire Rated



Windstorm
Resistant



Outdoor
Rated



Burglary
Rated

Dimensions

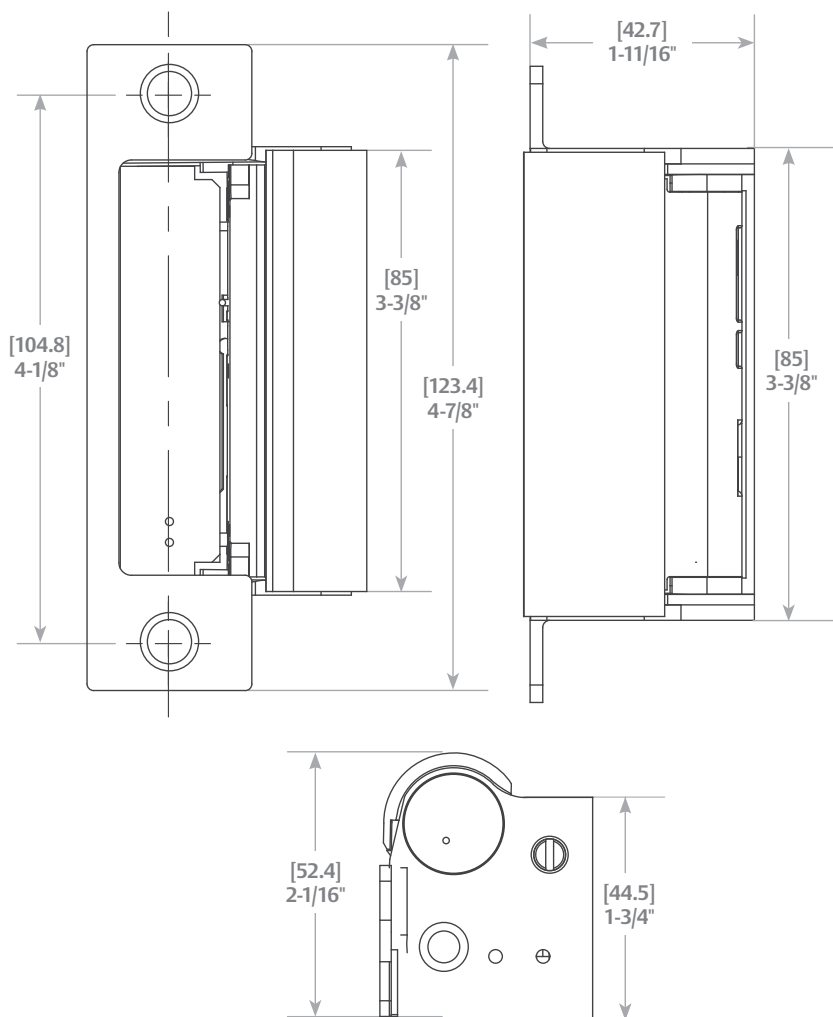

Diagram shown with cylindrical faceplate

Specifications

Certifications

- ANSI/BHMA A156.31, Grade 1
- UL 1034 burglary-resistant listed and suitable for outdoor use
- UL 294 (6th Edition) listed
- RoHS compliant
- UL 10C fire-rated, 3 hour single door (fail secure only)
- UL 10C fire-rated, 1-1/2 hour double door (fail secure only)
- CAN/ULC-S104 fire door conformant
- NFPA-252 fire door compliant
- ASTM-E152 fire door compliant
- ANSI/SDI A250.13 windstorm resistant
- Florida Building Code approved TAS 201, 202, 203
- ANSI-ASTM E330
- Sustainability documentation

Frame Application

- Metal
- Wood

Electrical (DC Continuous Duty)

- Dual Voltage 12/24 VDC
- 450 mA at 12 VDC / 250 mA at 24 VDC

Note: DC must be well filtered with ripple less than 1 volt 12ms.

How to Order

| Series | Model | Fail Safe / Secure | Finish* | Option (s) |
|---|--|---------------------------------------|-----------------------------------|--------------------------------------|
| 1006 | — | — F | — 630 | — LBM |
| 1006 Universal Electric Strike Faceplates ordered separately | CS* Complete Electric Strike; Includes the SMART Pac II and J, KD, KM, HM, ND faceplates and brackets | F Fail Safe / Secure | 605 Bright Brass | LBM Latchbolt Monitor |
| | | (blank) Fail Secure (standard) | 606 Satin Brass | LBSM Latchbolt Strike Monitor |
| | CS* Complete Electric Strike; Includes the SMART Pac II and J, KD, KM, HM, ND faceplates and brackets | | 612 Satin Bronze | |
| | CDB* Complete Electric Strike for Deadbolt Locks; Includes the ND and HM faceplates | | 613 Bronze Toned | |
| | CAS* Complete Electric Strike for Deadbolt Locks; Includes the N, ND and NM faceplates | | 629 Bright Stainless Steel | |
| | | | 630 Satin Stainless Steel | |

*Complete Pacs are only available in the 630 finish

HES 1006CS Smart Strike™

*The Complete One Box Solution
for all cylindrical and mortise locksets,
with or without a 1" deadbolt*

The 1006CS Smart Strike includes a 1006 electric strike body and SMART Pac® III plus faceplates and brackets that can provide the same function as any of the following options:

| | | |
|-----------|-----------|------------|
| J Option | H Option | HTD Option |
| K Option | HD Option | N Option |
| KD Option | HM Option | ND Option |
| KM Option | HT Option | NM Option |

Compatible Locksets

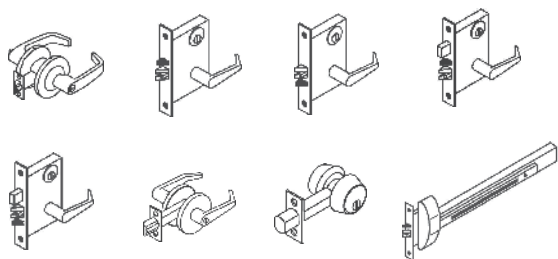

HES 1006CLB Complete for Latchbolt Locks

*The Complete One Box Solution for all
cylindrical and mortise locksets*

The 1006CLB includes the 1006 electric strike body plus faceplates and brackets that provide the same function as any of the following options:

| | |
|----------|-----------|
| J Option | KD Option |
| K Option | KM Option |

Compatible Locksets

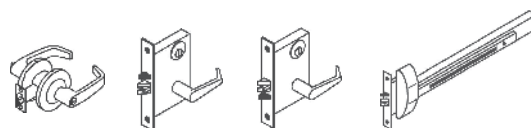

HES 1006CAS Complete for Recapture

*The Complete One Box Solution
for deadbolt recapture*

The 1006CS Smart Strike includes a 1006 electric strike body and SMART Pac® III plus faceplates and brackets that can provide the same function as any of the following options:

| | | |
|-----------|-----------|-----------|
| A Option | N Option | T Option |
| AD Option | ND Option | TD Option |
| AM Option | NM Option | |

Compatible Locksets

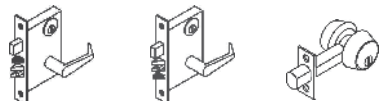

HES 1006CDB Complete for Deadbolt Locks

*The Complete One Box Solution for
all locksets with a 1" deadbolt*

The 1006CDB includes the 1006 electric strike body plus faceplates and brackets that provide the same function as any of the following options:

| | | |
|-----------|------------|-----------|
| H Option | HT Option | ND Option |
| HD Option | HTD Option | NM Option |
| HM Option | N Option | |

Compatible Locksets

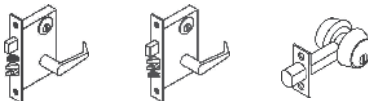

HES 1006 Series Faceplate Options



Operation: After releasing the latchbolt, the keeper returns to the locked position

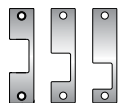

4-7/8" × 1-1/4"

LB Option

The Latchbolt Solution: Includes all hardware to accommodate every cylindrical and mortise lock up to a 3/4" latchbolt
Replaces function of the J, K, KM and KD Options.

» ANSI/BHMA Numbers: E09321, E09322, E09323

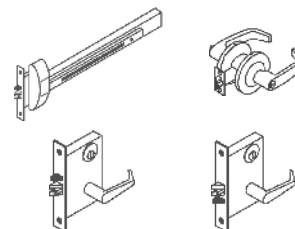

Operation: This deadbolt solution offers two modes of functionality; night latch, lockout. (Functional operation modes described below.)

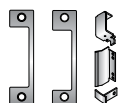

4-7/8" × 1-1/4"

DB Option

The Deadbolt Solution: Includes all hardware to retain and release all mortise and cylindrical locks with up to a 1" deadbolt

Mode 1: Night latch function. The deadbolt is retracted during traffic hours. The latchbolt is released by the keeper and keeper returns to the locked position.

Mode 2: Lockout function. The electric strike will not release if the deadbolt is extended.

Replaces function of the N, ND, NM, H, HD, HM, HT, and HTD options

» ANSI/BHMA Numbers: E09391, E09392, E09393, E09331, E09332, E09333

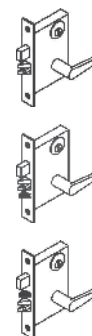

Operation: Latchbolt and deadbolt are released by a single keeper. The keeper is held open to recapture the latchbolt and deadbolt when the door is closed.

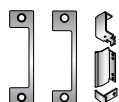

4-7/8" × 1-1/4"

CAS Option

The Continuous Deadbolt Recapture Solution: Includes all hardware to retain, release and recapture all mortise locks and tubular locks with up to a 1" deadbolt.

Mode 3: Normally extended deadbolt. Latchbolt and deadbolt are released by a single keeper. The keeper is held open to recapture the latchbolt and deadbolt when the door is closed.

Replaces the N, ND, NM, A, AM, AD, T and TD options

» ANSI/BHMA Numbers: E09391, E09392, E09393, E09331, E09332, E09333

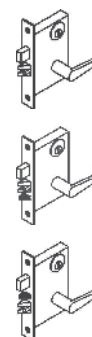

"For use with" information is offered as a recommendation only. Reference should be made to the lockset manufacturer for proper installation instructions necessary to meet compatibility requirements.

HES 1006 Series Faceplate Options



Operation: After releasing the latchbolt or deadbolt the keeper returns to the locked position

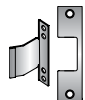

4-7/8" × 1-1/4"

E Option

For use with: Corbin Russwin Security Bolt, Weiserbolt and normally extended 1" tubular deadbolts

» ANSI/BHMA Numbers: E09391, E09392, E09393

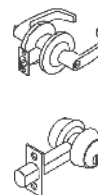

Operation: The hookbolt is released by a single keeper. The keeper is held open to recapture the latchbolt and hookbolt when the door is closed.

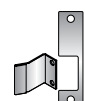

4-7/8" × 1-1/4"

R Option

For use with: Adams Rite style hookbolt up to 1" throw

» ANSI/BHMA Numbers: E09391, E09392, E09393, E09332, E09333



Operation: After releasing the latchbolt, the keeper returns to the locked position



4-7/8" × 1-1/4"

Z Option

For use with: Unit and Mono locks

» ANSI/BHMA Numbers: E09321, E09322, E09323

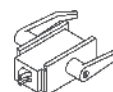

Operation: After releasing the latchbolt, the keeper returns to the locked position



9" × 1-3/8"

J-2 Option

For use with: All cylindrical locks up to a 3/4" latchbolt

» ANSI/BHMA Numbers: E09321, E09322, E09323



Operation: After releasing the latchbolt, the keeper returns to the locked position



9" × 1-3/8"

KM-2 Option

For use with: Mortise locksets up to a 3/4" latchbolt

» ANSI/BHMA Numbers: E09321, E09322, E09323

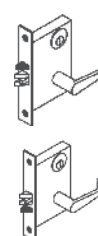

HES 1006 Series Faceplate Options



Operation: After releasing the latchbolt, the keeper returns to the locked position



9" × 1-3/8"

KM-2 Option

For use with: Mortise locksets up to a 3/4" latchbolt

» ANSI/BHMA Numbers: E09321, E09322, E09323

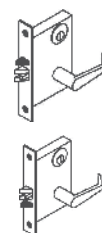

Operation: This deadbolt solution offers two modes of functionality; night latch and lockout. (functional operation modes described below.)



9" × 1-3/8"

DB-2 Option

The Deadbolt Solution: Includes all hardware to retain and release all mortise and cylindrical locks with up to a 1" deadbolt.

Mode 1: Night latch function. The deadbolt is retracted during traffic hours. The latchbolt is released by the keeper and keeper returns to the locked position.

Mode 2: Lockout function. The electric strike will not release if the deadbolt is extended.

Replaces the N-2 and H-2 options

» ANSI/BHMA Numbers: E09391, E09392, E09393, E09331, E09332, E09333

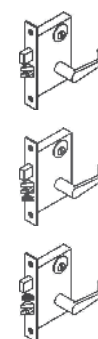

Operation: Latchbolt and deadbolt are released by a single keeper. The keeper is held open to recapture the latchbolt and deadbolt when the door is closed.



9" × 1-3/8"

CAS-2 Option

The Deadbolt Solution: Includes all hardware to retain, release and recapture all mortise locks and tubular locks with up to a 1" deadbolt.

Mode 3: Normally extended deadbolt. Latchbolt and deadbolt are released by a single keeper. The keeper is held open to recapture the latchbolt and deadbolt when the door is closed.

Replaces the N-2, A-2 and T-2 options

» ANSI/BHMA Numbers: E09391, E09392, E09393, E09331, E09332, E09333

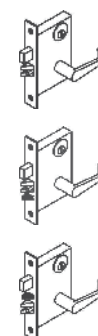

Operation: After releasing the latchbolt, the keeper returns to the locked position



4-7/8" × 1-1/4"

J Option

For use with: Cylindrical locksets up to 3/4" throw and all locksets with center-lined bolts

Compatible locksets: All brands of cylindrical latchbolts

» ANSI/BHMA Numbers: E09321, E09322, E09323



"For use with" information is offered as a recommendation only. Reference should be made to the lockset manufacturer for proper installation instructions necessary to meet compatibility requirements.

HES 1006 Series Faceplate Options



Operation: After releasing the latchbolt, the keeper returns to the locked position



4-7/8" × 1-1/4"

KD Option

For use with: Mortise locksets up to 3/4" throw latchbolt

Compatible locksets: Dorma 9500, Jackson, Sargent (7700 & 8100), Schlage, Yale (8700)

» ANSI/BHMA Numbers: E09321, E09322, E09323



4-7/8" × 1-1/4"

KM Option

For use with: Mortise locksets up to 3/4" throw latchbolt

Compatible locksets: Accurate, Arrow, Baldwin, Best, Corbin Russwin, Falcon, Marks, PDQ, Sargent (7800, 8200 & 9200), Yale (8800)

» ANSI/BHMA Numbers: E09321, E09322, E09323



Operation: Lockout function. The electric strike will not release if the deadbolt is extended. The deadbolt is retracted during traffic hours. The latchbolt is retracted by the keeper. The keeper returns to the locked position.



4-7/8" × 1-1/4"

HM Option

For use with: Mortise locksets with a 1" deadbolt.

Strike will not release when deadbolt is extended

Compatible locksets: Accurate, Arrow, Baldwin, Best, Corbin Russwin, Falcon (45H, 47H, 34H & 37H), Marks, Omnia, PDQ, Sargent (7800, 8200 & 9200), Yale (8800)

» ANSI/BHMA Numbers: 09391, E09392, E09393, E09331, E09332, E09333

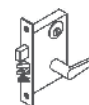

4-7/8" × 1-1/4"

HTD Option

For use with: tise locksets with a 1" deadbolt and no deadlatch or a center positioned deadlatch. Strike will not release when deadbolt is extended

Compatible locksets: Sargent (7700 & 8100), Schlage, Yale (8700)

» ANSI/BHMA Numbers: E09391, E09392, E09393, E09331, E09332, E09333

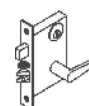

"For use with" information is offered as a recommendation only. Reference should be made to the lockset manufacturer for proper installation instructions necessary to meet compatibility requirements.

[Continued on next page »](#)

HES 1006 Series Faceplate Options



Operation: Night latch function. The deadbolt is retracted during traffic hours. The latchbolt is released by the keeper and keeper returns to the locked position.



4-7/8" × 1-1/4"

ND Option

For use with: Mortise locksets with a deadbolt used for night latch function only

Compatible locksets: Sargent (7700 & 8100), Schlage, Yale (8700)

» ANSI/BHMA Numbers: E09391, E09392, E09393, E09331, E09332, E09333

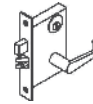

4-7/8" × 1-1/4"

NM Option

For use with: Mortise locksets with a deadbolt used for night latch function only

Compatible locksets: Accurate, Arrow, Baldwin, Best, Corbin Russwin, Falcon (45H, 47H, 34H & 37H), Marks, Omnia, PDQ, Sargent (7800, 8200 & 9200), Yale (8800)

» ANSI/BHMA Numbers: E09391, E09392, E09393, E09331, E09332, E09333

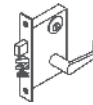

The following legacy faceplate options remain available for order. Suggestions are provided below for more versatile options.

H Option replaced by **HM Option**
HD Option replaced by **HTD Option**
HT Option replaced by **HTD Option**
K Option replaced by **KM Option**

K-2 Option combined into **KM-2 Option**
A-2 Option replaced by **CAS-2 Option**
H-2 Option replaced by **DB-2 Option**
N-2 Option replaced by **DB-2 Option**
T-2 Option replaced by **CAS-2 Option**

"For use with" information is offered as a recommendation only. Reference should be made to the lockset manufacturer for proper installation instructions necessary to meet compatibility requirements.

HES 1006 Series Faceplate Dimensions

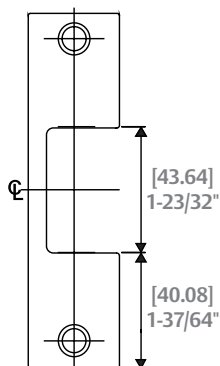
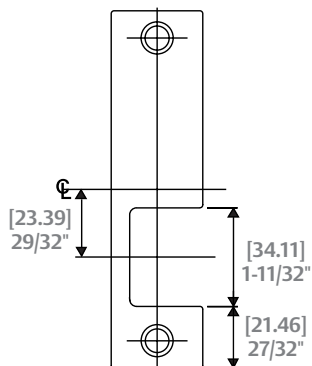
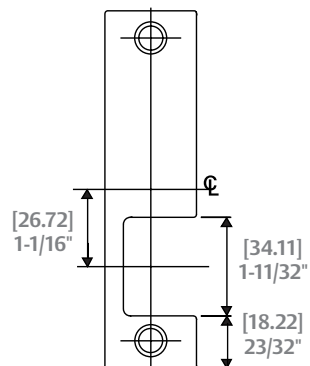
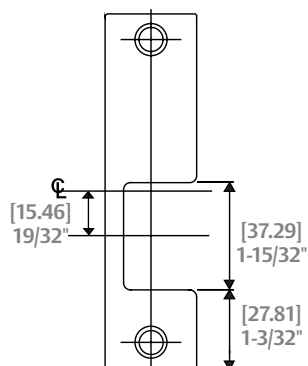
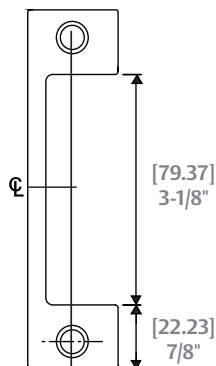
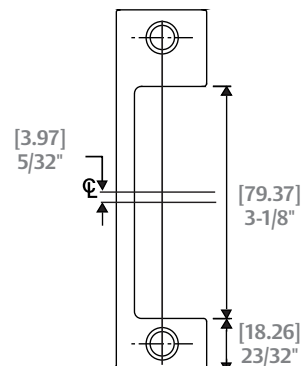
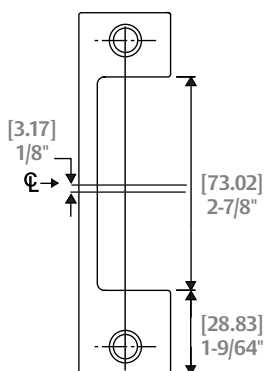
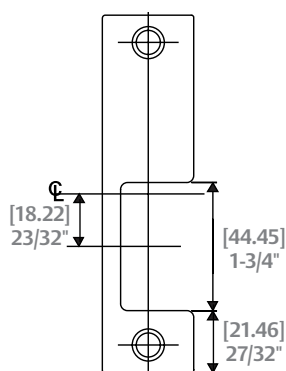
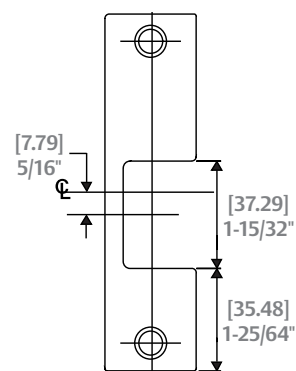
J, E
Faceplate Option**K**
Faceplate Option**KD**
Faceplate Option**KM**
Faceplate Option**H, HT, N**
Faceplate Option**HD, ND,**
Faceplate Option**HM, NM**
Faceplate Option**R**
Faceplate Option**Z**
Faceplate Option

"For use with" information is offered as a recommendation only. Reference should be made to the lockset manufacturer for proper installation instructions necessary to meet compatibility requirements.

HES 1006 Series Faceplate Dimensions

J-2
Faceplate Option

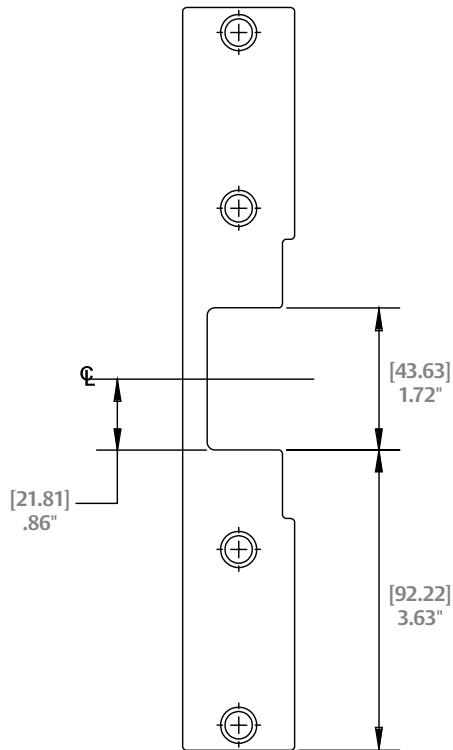

K-2
Faceplate Option

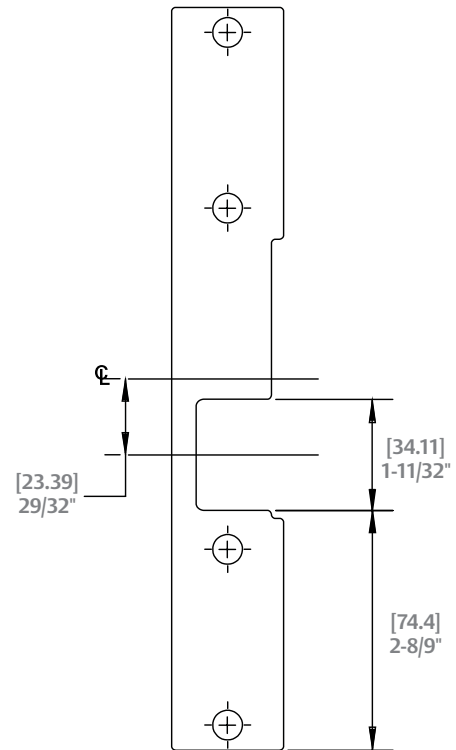

KM-2
Faceplate Option

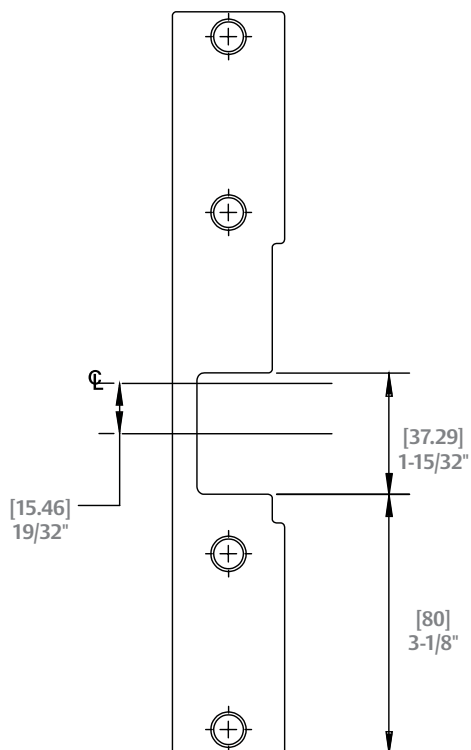

N-2, H-2
Faceplate Option

